

Updated
Covid-19

School Information
November 2020

YEAR 11



There are some important changes to the arrangements for after half term. Please read this leaflet carefully.

IMPORTANT

From 2nd November 2020, all homework and classwork, if self-isolating, will be set using **School Synergy**. This means that **eSchools** WILL NOT be used for any form of communication for parents or pupils.

Parents should contact school using Synergy for all enquiries including attendance, appointments and support.

Parents and pupils can access this by clicking on the tab 'School Synergy' on the school's website. Pupils should sign in using the Microsoft 365 link and use their school email address and password.

We will be resuming our paid breakfast service for Year 11 pupils. This will restart on Monday 2nd November in the main dining room.

LONGRIDGE HIGH SCHOOL

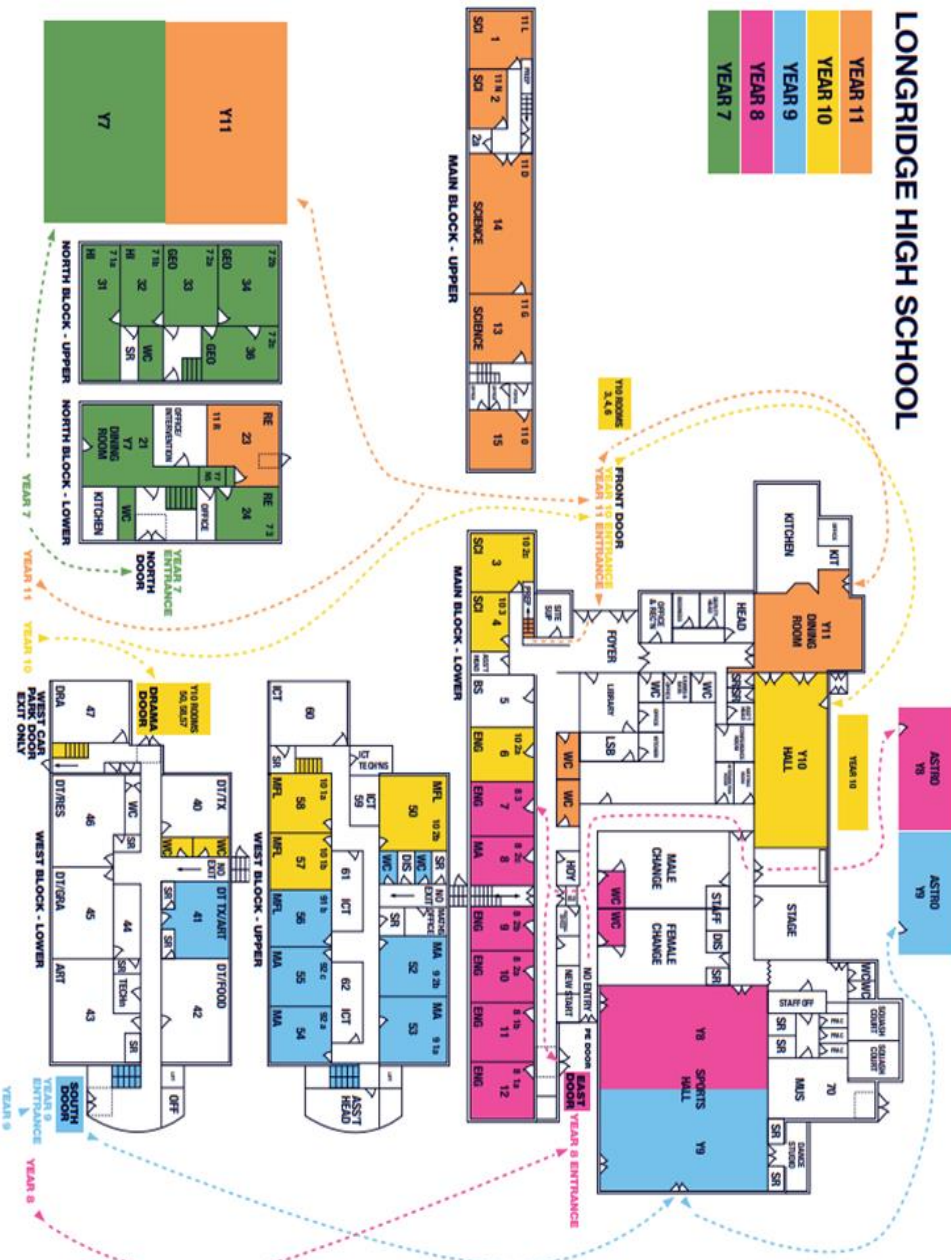

Year 11 Information

Year 11 should enter by the **main entrance gate only**. You should gather in the back section of the schoolyard (netball courts). You should enter and exit school through the **main entrance**. **Pupils in Rooms 13 and 15 should exit and enter through Room 14 and not use stairs outside their classroom.** Your toilets are on the main corridor.

Break and Lunchtime

Your outside area is the back half of the netball courts furthest from the road. Do not cross over in to the other section of the yard at any time. Your food is served in the main dining room. Enter and exit using the exit doors. You can eat packed lunches here as well as food bought from school. We are unable to provide a water refilling station.

Fire Assembly point

The designated area is the back of the yard (netball courts) furthest from the road. Line up in alphabetical order in form order.

End of day

All pupils will be dismissed from lessons at 3pm. This is the same for walkers or pupils catching public transport/lifts. You must leave by the **main school entrance gate** only.

Number 1 bus queue - In front of Room 3.

Movement around school

At the end of lessons, Year 11 pupils in Rooms 13 and 15 may use the stairs to access option subjects in West Block. When moving to PE, you should exit school by the main entrance and go around the back of school behind the Sports Hall and line up outside East door. You are not allowed to access PE along the main corridor.

Year 11 Anchor Rooms

From Monday 2nd November, Year 11 will register and have lessons in Rooms 1,2,13,14,15 and 23.

Y11 Form group	Form tutor	Anchor room
11D	Mr Ringrose	14
11R	Mrs Place	23
11G	Mr Connell	13
11N	Mr Gordon	2
11O	Miss Socha	15
11L	Mrs Mason	1

In Classrooms

- You will be taught in different sets and classrooms for all your subjects.
- Make sure you always sit in your allocated seat.
- Keep your exercise books in your teaching rooms. (Don't take them home unless asked to do so.)
- Make sure you keep your exercise books in the correct pile in the classroom.
- Bring your writing equipment/homework/pupil planner with you every day.
- Return all equipment to the resource area when you have finished with it – glue/scissors/colouring pens/whiteboards.
- Make sure your desk and floor area are neat and tidy at the end of the school day

You must not enter another zone in the school.